

Accessories

Connectors and Pins for all Systems

TT / XT
ST / FT

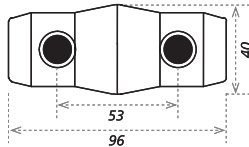

CS3-CON
Connector (Spigot)

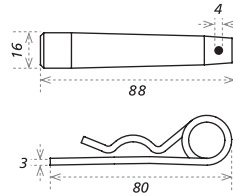

CS3-TP + CS3-RS3
Trusspin + R-Clip 3mm / 0,12in

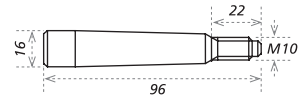

CS3-TPS + CS3-NUT
Pin + Locknut M10

XD

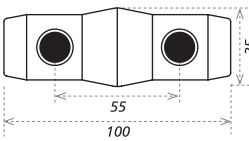

CS2-CON
Connector (Spigot)

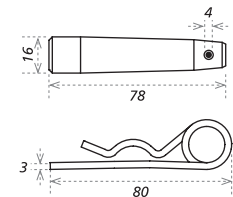

CS2-TP + CS3-RS3
Trusspin + R-Clip 3mm / 0,12in

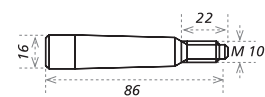

CS2-TPS + CS3-NUT
Pin + Locknut M10

HD
FD

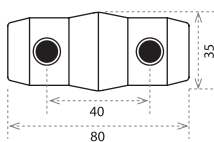

CS1-CON
Connector (Spigot)

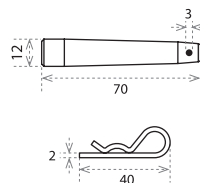

CS1-TP + CS1-RS2
Trusspin + R-Clip 2mm / 0,08in

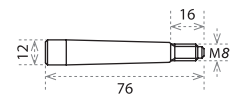

CS1-TPS + CS1-NUT
Pin + Locknut M8

Connectors and Pins

All Eurotruss connectors are made accordingly the highest quality standard.

Eurotruss only uses the aluminium quality ENAW-6082 T6 for the connectors. All Eurotruss connectors are engraved with the Eurotruss logo and name to check the originality.

The Truss Pin is made of high tensile steel, 42 CrMo 4, which prevents deformation and can absorb higher loadings.

Spacers

In various designs and constructions like Ground Supports, spacers are required.

Spacer get the matching size without compromising the use of standard elements.

Accessories

Spacers, Bold on Receivers and Scons for all Systems

SPACER

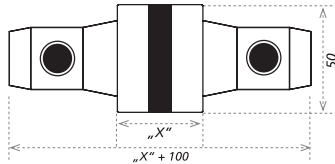

CS2-CON40
XD-Spacer, X=40mm / 1,57in

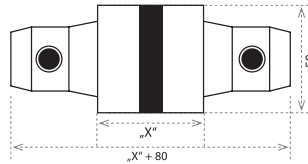

CS1-CON15 / 30 / 50 / 80
HD/FD-Spacer, X = 15, 30, 50, 80mm
(0,59 / 1,18 / 1,97 / 3,15in)

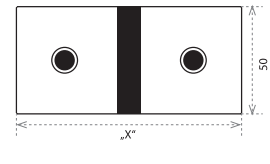

CS1-BUS90 / 105
HD/FD-Adapter, X = 90 mm, 105 mm
(3,54 / 4,13in)

BOLD ON RECEIVER

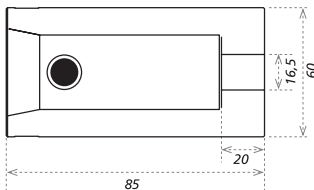

CS3-BOB85
TT/XT/FT and ST-Bold on Receiver 85mm (3,35in)

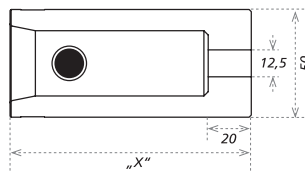

CS2-BOB95
XD-Bold on Receiver 95 mm (3,74in)

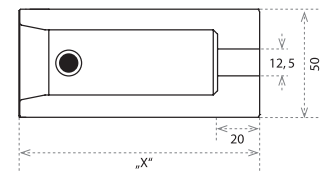

CS1-BOB100
Bold on Receiver,
100mm (3,94in),
for BLK-44
(Cornerblock)

CS1-BOB105
Bold on Receiver,
105mm (4,13in),
for BLK-34
(Cornerblock)

SCONS

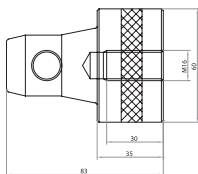

CS3-Scon35
TT / XT / ST / FT
Bold on Connector M12

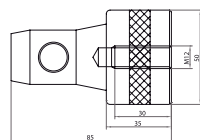

CS2-Scon35
XD
Bold on Connector M12

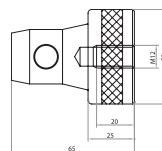

CS1-Scon25
HD/FD
Bold on Connector M12

Bold on Receivers

Eurotruss supplies various kinds of bold on receivers.

The screw in bold on receivers (connectors) in FD and XD System which are being used on all kind of plated products like totem, adapter plates and the swivel corner / base.

The other bold on receivers are to be used on corner blocks to make the various attachments.

Scons

The screw in half connectors (Scons) in FD and XD System which are being used on all kind of plated products like totem, adapter plates, book corners and the swivel corner / base.

Both Scons have a M12 Thread inside.

Accessories

Hinge Connection for all HD / FD Systems



L



R

CS1-HS L/R

HD / FD Hinge Set (single tube), L=100mm

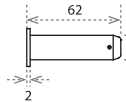
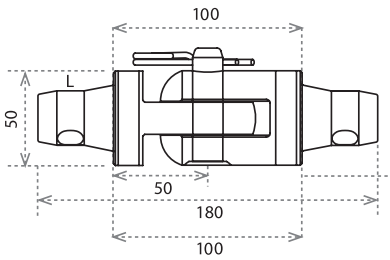

CS1-Pin01

Pin 16 mm for HS and hinges

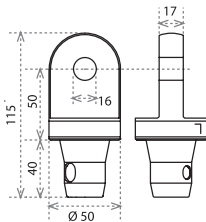

CS1-HSP-M L

Hingepart male left for HD, FD Serie

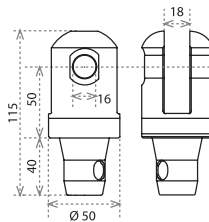

CS1-HSP-F L

Hingepart female left for HD, FD Serie

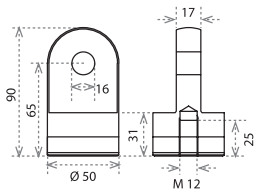

CS1-HS-Bo M

Hingepart Bold on male for HD, FD Serie

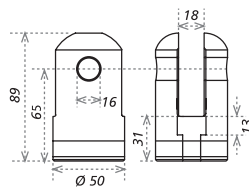

CS1-HS-Bo

Hingepart Bold on female for HD, FD Serie

Example FD34 Connection with usage of hinges

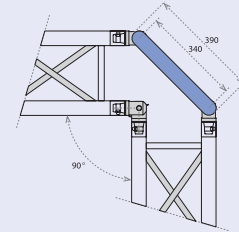

CS1-DB340

Distance Bar

for Hinge Part 90°: 390mm (15,35in)

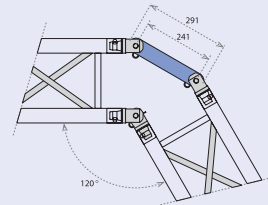

CS1-DB241

Distance Bar

for Hinge Part 120°: 291mm (11,46in)

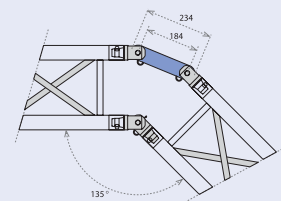

CS1-DB184

Distance Bar

for Hinge Part 135°: 234mm (9,21in)

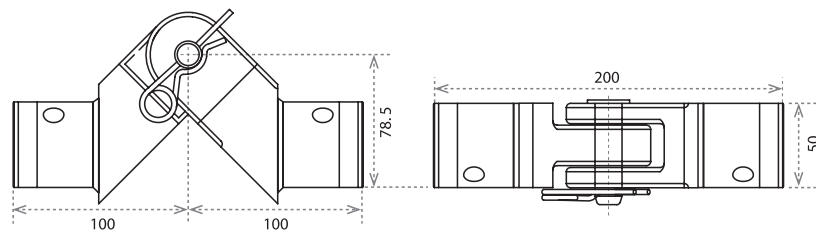

CS1-CSLD

HD / FD Variable Connection Set, 0-180°

Hinge Connections

The hinge sets, mainly used as hinges in towers, are also usable to make various shapes with standard lengths.

With pre-fixed distance bars you can make 90 dgr., 120 dgr. and 135 dgr. corners. See the example above for more details. The hinge sets are available for HD/FD and for ST System.

The hinges for ST System are mainly designed for hinging the tower and to be used in combination with TD50 Tower.

The variable connection set can be used to make any angle between 0 dgr. and 180 dgr and can only be used with square truss.

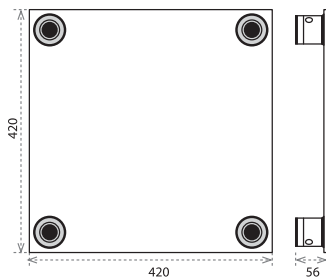

PLB-44
Base Plate

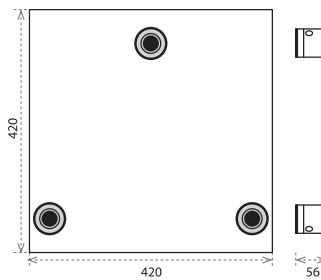

PLB-43
Base Plate

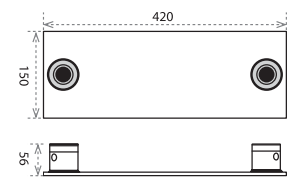

PLB-42
Base Plate

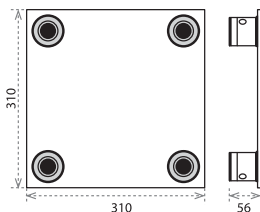

PLB-34
Base Plate

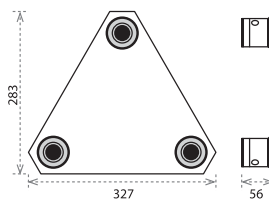

PLB-33
Base Plate

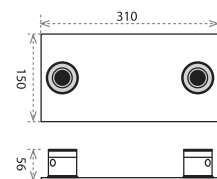

PLB-32
Base Plate

Base Plates

For each Truss System Eurotruss supplies a base plate. The base plate is an aluminium plate with fixed welded receivers on it.

The plate is for FD System 6mm (0,24in) thick and for heavier truss systems 8~10mm (0,31~0,39in) thick. A base plate can also be used as a wall plate or end plate.

Accessories

Totem Plates for all HD / FD Systems

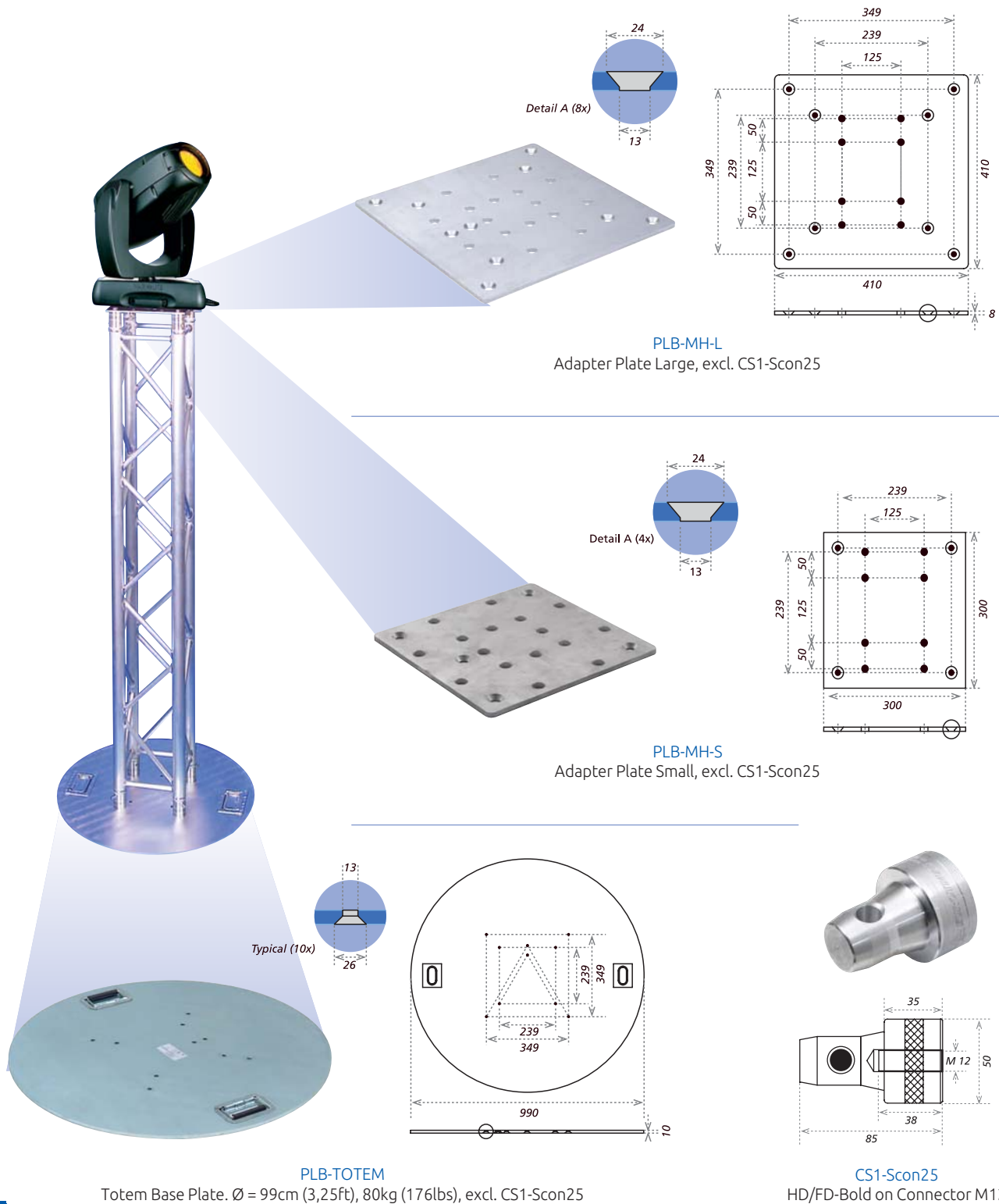

Totem

The Totem is a round steel base plate with a diameter of 99cm (3,25ft) with easy handles and pre-drilled holes for all HD/FD Truss Series. The totem is strong, elegant and the perfect plate for stand alone beams.

The totem can also be used to mount a moving head (any brand) on a top plate. In order to secure the moving head, it is advisable to use a special adapter plate including a spacer set with locking device to fixate the moving head.

Not only is the adapter plate the right tool for fast and safe fixation of your moving head, it can also absorb the heat generated by the moving head without deforming.

The adapter plates are available in two sizes and equipped with pre-drilled holes to match all moving heads. Both Totem Plate and Adapter Plate are exclusive the required HD/FD Scon25, half connector with M12 Thread.

Accessories

Couplers and Joints and Gripping Material for all HD / FD Systems

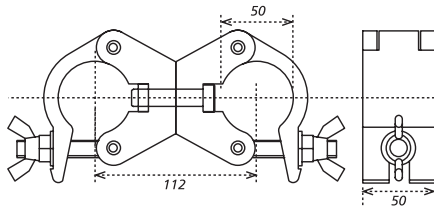

DC-DC
Swivelcoupler

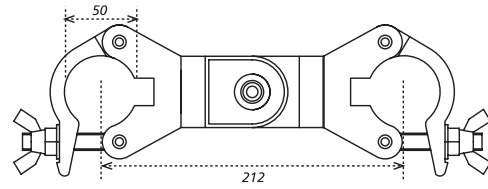

DCDC-TD
Double Swiveljoint

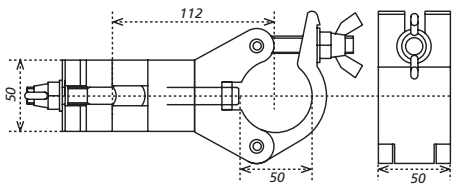

DC-DC-F
90° Fixed Coupler

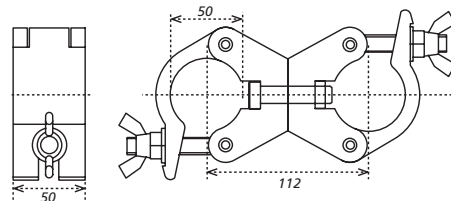

DC-DC-P
Parallel Coupler

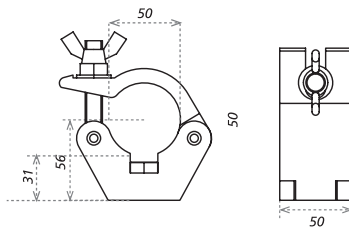

DC-HC
Halfcoupler

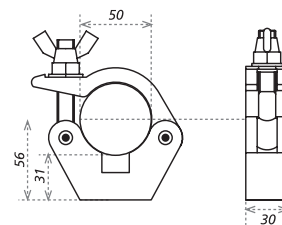

DC-SC
Halfcoupler Slimline

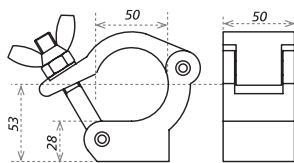

DC-HC-SE
Halfcoupler »side entry«

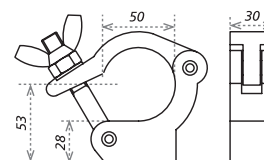

DC-SC-SE
Halfcoupler Slimline »side entry«



Totem

Depending on triangular or square truss additional 3 or 4 HD/FD-Scon25 may need to be ordered as extra.

Gripping Material

Eurotruss carries a broad range of couplers, clamps, hook on bars, stabilizer bars and hanging bars.

A good solution for using couplers with truss constructions is the side-entry coupler as the lid has a wide angle which provides more space tolerance.

Accessories

Hanging Adapter for conical systems



DCB8-PF
TT Truss Hanging Adapter

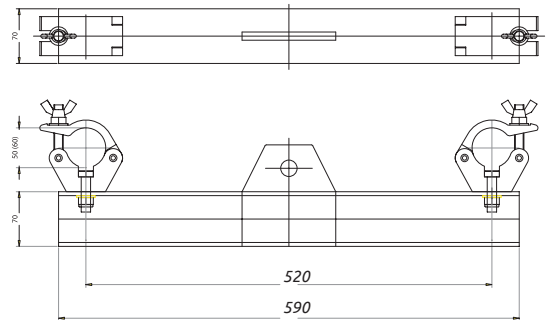

DCB7-PF
XT Truss Hanging Adapter

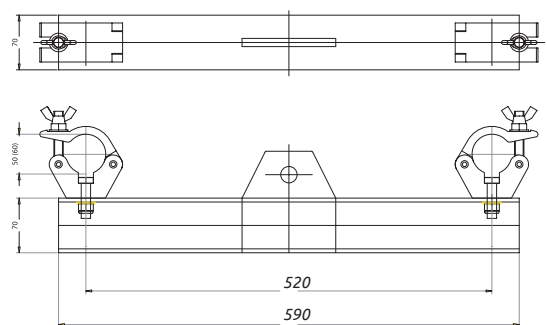

DCB5-PF
ST Truss Hanging Adapter

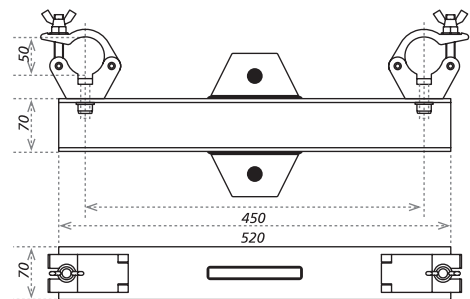

DCB4-PF
HD/FD4X Truss Hanging Adapter

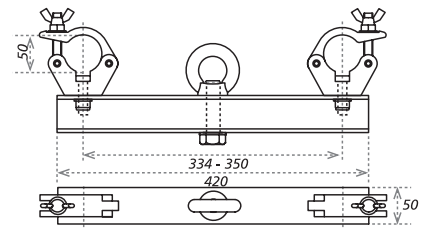

Hanging Adapter

Special steel hanging adapter to absorb the required load.

The hanging bars perfectly match the truss systems requirements.

The hook on bars are available in various lengths and with various wall thicknesses.

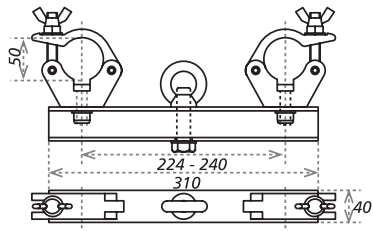

DCB3-PF
HD/FD3X Truss Hanging Adapter

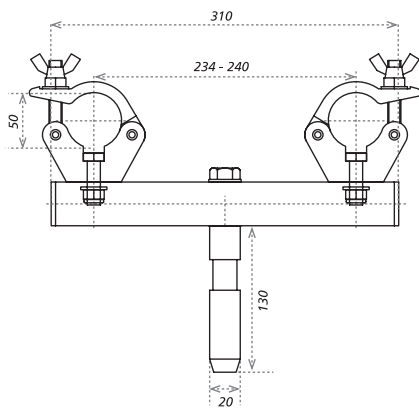

DCTV3-PF
Truss Adapter TV, Swivel

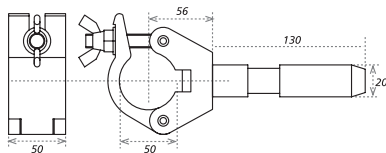

DC-TV
Half Coupler with TV Spigot

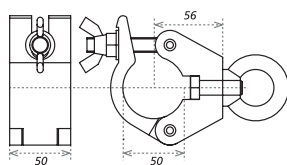
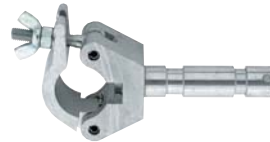

DC-PF
One Point Hanging Adapter



Hanging Adapter

Special steel hanging adapter to absorb the required load.

The hanging bars perfectly match the truss systems requirements.

The hook on bars are available in various lengths and with various wall thicknesses.

Accessories

Bold on Twist joints – Stabilizer and Hook on Bars

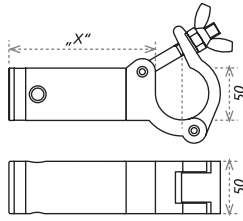

CS2-DC13
 XD Bold on Twist Joint 13cm (5,12in)
 – to make T-joint
 i.c.w. XD Sleeve Blocks

CS2-DC21
 XD Bold on Twist Joint 21cm (8,27in)
 – to make T-joint i.c.w. XD Corners

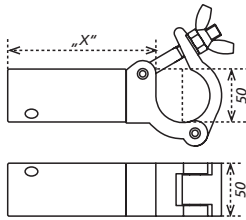

CS1-DCX

HD / FD Bold on Twist Joint
 X = 10 / 10,5 / 12 / 14 / 21cm = 3,94 / 4,13 / 4,72 / 5,51 / 8,27in
 *usage of 50mm (1,97in) half coupler side entry

CS1-DC10 – Bold on Twist Joint 100mm / 3,94in
 – to make T-joint i.c.w. HD/FD44 Corners

CS1-DC10,5 – Bold on Twist Joint 105mm (4,13in)
 – to make T-joint i.c.w. HD/FD34 Corners

CS1-DC12 – Bold on Twist Joint 120mm (4,72in)
 – to make T-joint i.c.w. HD/FD34 Sleeve Block

CS1-DC14 – Bold on Twist Joint 140mm (5,51in)
 – to make T-joint i.c.w. HD/FD44 Sleeve Block

CS1-DC21 – Bold on Twist Joint 210mm (8,27in)
 – to make T-joint i.c.w. HD/FD34 Corners

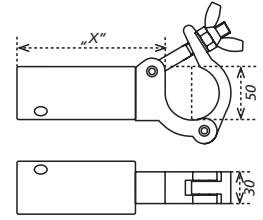

CS1-DCXS

HD / FD Bold on Twist Joint, Slimline
 X = 10 / 10,5 / 12 / 14 / 21cm = 3,94 / 4,13 / 4,72 / 5,51 / 8,27in
 *usage of slimline 30mm (1,18in) half coupler side entry

CS1-DC10S – Bold on Twist Joint 100mm / 3,94in
 – to make T-joint i.c.w. HD/FD44 Corners

CS1-DC10,5S – Bold on Twist Joint 105mm (4,13in)
 – to make T-joint i.c.w. HD/FD34 Corners

CS1-DC12S – Bold on Twist Joint 120mm (4,72in)
 – to make T-joint i.c.w. HD/FD34 Sleeve Block

CS1-DC14S – Bold on Twist Joint 140mm (5,51in)
 – to make T-joint i.c.w. HD/FD44 Sleeve Block

CS1-DC21S – Bold on Twist Joint 210mm (8,27in)
 – to make T-joint i.c.w. HD/FD34 Corners



KCKC-X
 Bold on Corner Brace
 70/ 140/ 200/ 300cm
 2,3/ 4,6 / 6,56 / 9,84ft
 All lengths available

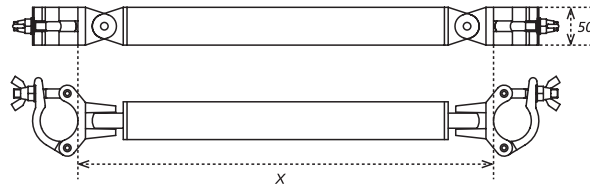

HCHC-X
 Hook on Bar
 100/ 200/ 300cm
 3,28/ 6,56 / 9,84ft
 All lengths available

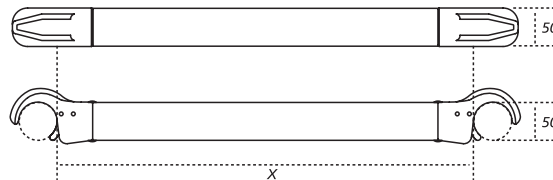

Bold on Twist Joints

Eurotruss supplies prefixed bold on twist joints which can be used as a T-connection.

The sizes do match with standard T-joints in standard rigs and ground supported rigs. The slim line version has the advantage that it requires less mounting space as sometimes the braces of the attached truss can be in the way.

Stabilizers and Hook on bars

Bold on Corner braces are available in various lengths and required in the Ground Supports and Rigs which exceeds a height of 6m / 19,69ft.

The hook on bar is available in various lengths and with various wall thicknesses.